

DS Fixing Bolt 2PCS

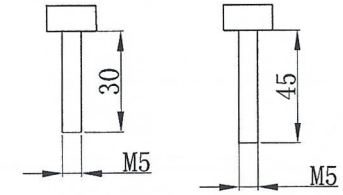

Screw M5x30 2PCS
Screw M5x45 2PCS

Desk-Top Series	OUTPUT (2) Schuko Socket (16A Rated)	OPERATING TEMPERATURE 0° to 60°C
INPUT 250VAC 16A 50HZ (1) EPS7104 Socket	BRANCH CIRCUITS (NONE)	MOUNTING ACCESORIES (2)DS Fixing Bolt (2)Screw M5x30 (2)Screw M5x45

Revisions		
Rev	Description	Date

DRAWING TYPE (NO PERMISSION, NO CHANGING)	Ratio Electric P/N	5008
unit=mm	Housing	Aluminium (Grey)
TECHNICAL STANDARD 1.JT11: 2.NO RUSTNESS 3.NO FLAW ON THE SURFACE		Endcover PA6GF (Black)
FILLET R0.5 ANGLE ±0.5° FIRST ANGLE 	 www.ratio-electric.com DATE 13-04-2015	
SCALE 1:3		